

Sometimes **"More"** Really Means **"More"**

CAPTIVATING . . . SECLUDED . . . INVITING

Experience **"THE WOODLANDS"** in Jordan Park Glen

Three Pristine Parcels Offered, with this being the **LAST** One Available

Oversized Lushly Vegetated .59 Acre Parcel in Highly Desirable Jordan Park Glen

NO Sewer Bond Assessment

NO Building Envelope Restriction

Bordered on North Side by Extensive Common Area, Parcel # 410-48-026A

Easy Access to Charming Uptown, Great Shopping, and Enjoyable Restaurants

Backing to Heavily Treed and Private Mormon Wash

Truly a **RARE** Opportunity in a **Perfect Setting** with **Amazing** Red Rock & Mountain Vistas

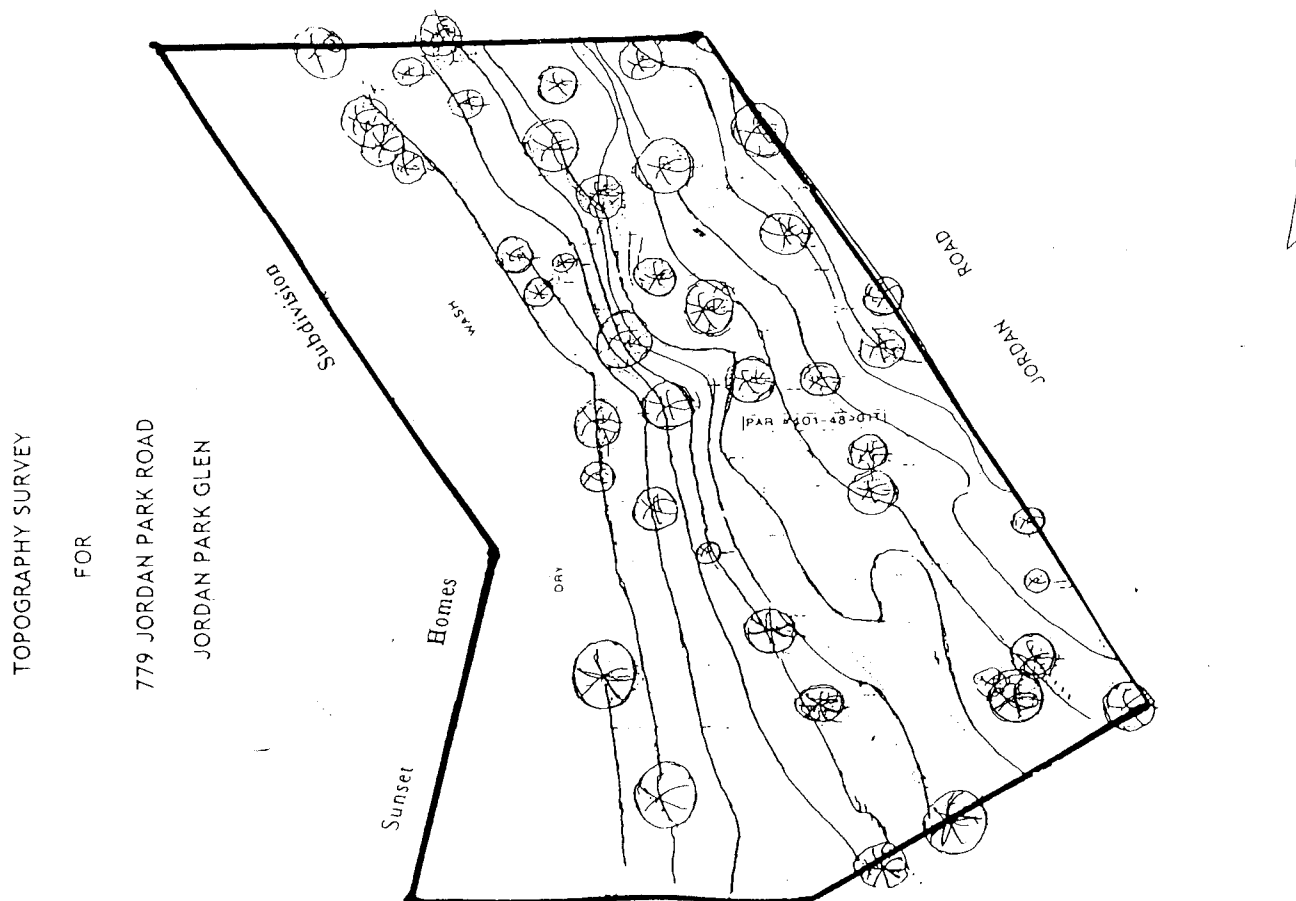

"The Woodlands" Common Goal

*A True Commitment by Architect, Stephen Thompson
to Take Your Dreams, Construct Them into Reality,
Creating a True Sense of Community You're Proud to Call Home!*